

“ Needless to say my eyedrops now last twice as long... in the past many drops ended up on eye lids or on the cheek! ”

AutoDrop® user



Ophthalmology

AutoDrop® and AutoSqueeze™



**HEAD OFFICE  
INTERNATIONAL SALES & MARKETING**

Owen Mumford Ltd  
Brook Hill, Woodstock  
Oxfordshire OX20 1TU, United Kingdom  
T : 01993 812021 F : 01993 813466  
E : info@owenmumford.co.uk

**UK / IRELAND SALES & MARKETING**

Owen Mumford Ltd  
Primsdown Industrial Estate  
Worcester Road, Chipping Norton  
Oxfordshire OX7 5XP, United Kingdom  
T : 01608 645555 F : 01608 646546  
E : info@owenmumford.co.uk

**NORTH AMERICA**

Owen Mumford Inc.  
1755 West Oak Commons Court  
Marietta, Georgia 30062, USA  
T : 800-421-6936 F : 770-977-2866  
E : info@owenmumfordinc.com

**FRANCE**

Owen Mumford  
BP 3333, 27950 Saint Marcel, France  
T : 02 32 51 88 70 F : 02 32 21 96 95  
E : contact@owenmumford-fr.com

**GERMANY**

Owen Mumford GmbH.  
Alte Häge 1  
63762 Großostheim-Ringheim, Germany  
T : 06026/97750 F : 06026/977529  
E : info@owen-mumford.de

[www.owenmumford.com](http://www.owenmumford.com)



Making eye drop application easy

**AutoDrop®**

Eye Drop Guide...



**AutoSqueeze™**

 OWEN MUMFORD

OP/6000-LTMCC/0911/8

# AutoDrop®

## Eye Drop Guide

Taking eye drops can be a challenge for many patients, young or old. **AutoDrop®** and **AutoSqueeze™** have been developed to make self administration as easy as possible – improving patient compliance and their reliance on others.

**AutoDrop®** and **AutoSqueeze™** are re-usable for the length of the treatment, providing a cost effective solution and making eye drop application simple.

### Unique design prevents blinking.

A pinhole draws the patient's gaze away from the descending drop, whilst a small lip holds the lower eyelid down, preventing blinking and improving patient compliance.

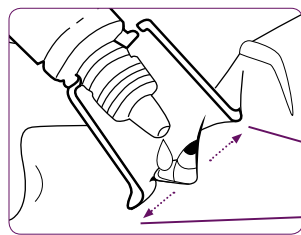
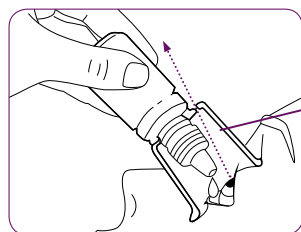

### Proven compatibility with most eye drop bottles.

**AutoDrop®** has been tested with hundreds of eye drops for compatibility, for a full, up-to-date list please visit [www.owenmumford.com](http://www.owenmumford.com)

### Prevents contamination and cross infection.

The eye drop container is kept well away from the eye at all times and the device is easy to clean.

### Delivers the drop in the right place every time.

The nozzle is positioned perfectly over the eye ensuring that drops are successfully delivered on the first attempt.

**AutoDrop®** and **AutoSqueeze™** have been designed to overcome common obstacles to patient compliance:

- Missing the eye with the drop.
- Blinking as the drop is delivered.
- Difficulty in squeezing the bottle to deliver the drop.



Developed together with the Royal National Institute for the Blind.

# AutoSqueeze™

Combine **AutoSqueeze™** with **AutoDrop®**, to make squeezing of the bottle easier.



Many patients who use eye drops have other conditions that affect their dexterity and ability to squeeze small eye drop bottles. **AutoSqueeze™** clips onto the bottle to provide a secure, ergonomic grip and extra leverage. It can be used in conjunction with **AutoDrop®** or on its own.

**AutoDrop®** is compatible with a number of eye drop devices on the market, including those listed below:

NAME	MANUFACTURER	SIZE
Chloromycetin (Redidrops)	Goldshield	5ml, 10ml
Ciloxan	Alcon	5ml
Genticin	Roche	10ml
Golden Eye	Typharm	10ml
Oftaquix	Kestral Ophthalmics	5ml
Alomide	Alcon	10ml
Betnesol	UCB	10ml
Emadine	Alcon	5ml
Maxidex	Alcon	5ml, 10ml
Maxitrol	Alcon	5ml
Voltarol Optha	Novartis	5ml

Tested as of November 2006

For a full up-to-date list, visit [www.owenmumford.com](http://www.owenmumford.com)