

How to use Autolet® Impression

Fig. 1

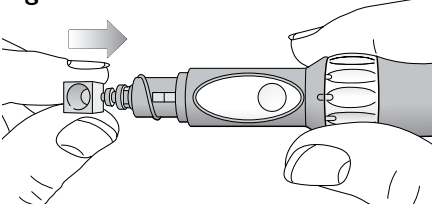

Fig. 2

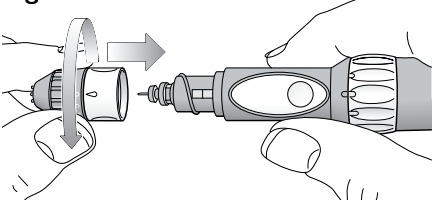

Fig. 3

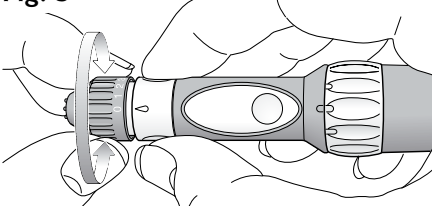

Fig. 4

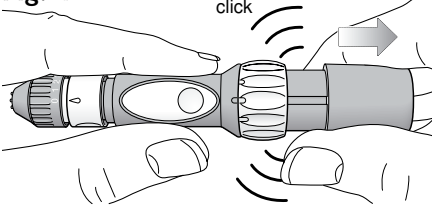

Fig. 5

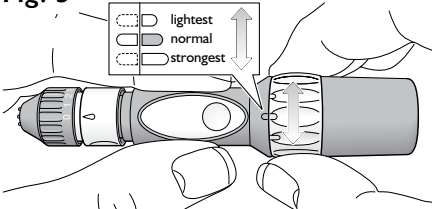

Fig. 6

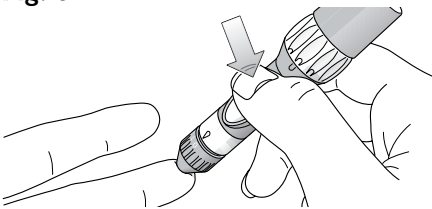
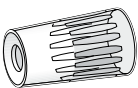
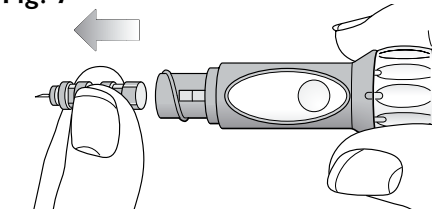

Fig. 7



PREPARING THE SITE

Wash your hands and the site of penetration with warm, soapy water. Rinse and dry thoroughly.

INSERTING THE LANCET

Insert a new lancet into the lancet holder and push down firmly until it is fully inserted. Remove the protective cap by twisting it away from the body of the lancet (fig. 1).

REPLACING THE DEPTH ADJUSTER

Replace the depth adjuster assembly onto the Autolet Impression by twisting it on (fig. 2).

SETTING THE PENETRATION DEPTH

Adjust the penetration depth as necessary. Hold the blue depth adjuster collar between thumb and forefinger and twist until the required depth setting lines up with the penetration depth indicator.

'0' provides the minimum penetration depth and '6' provides the maximum penetration depth. It is recommended you start at the minimum depth (fig. 3).

PREPARING TO TAKE THE SAMPLE

Hold the main body of Autolet Impression with one hand and the device sleeve with the other and pull the two apart until you hear a click. This primes the device ready for use (fig. 4).

SETTING THE SPRING FORCE

Autolet Impression has 3 unique spring force settings that increase or decrease the force at which the lancet penetrates the sampling site. To set the device to the desired setting, hold the main body of the Autolet Impression and then twist the force adjustment ring until the marker on the body is in line with the desired setting on the force adjustment ring (fig. 5).

OBTAINING THE SAMPLE

Hold the front end of Autolet Impression firmly against the sample site (fig. 6).

Press the release button and then remove Autolet Impression from the sampling site.

Wait for a moment to allow blood to flow freely to the site of penetration. Massage the site if necessary, from the palm to the fingertip, with the hand held downwards, until a sufficient blood sample is acquired.

REMOVING THE LANCET

Twist off the depth adjuster assembly to remove it from the Autolet Impression taking care not to touch the exposed lancet needle (fig. 7).

It is important to discard the used lancet carefully in a suitable sharps container. Do not reuse lancet.

Replace the depth adjuster assembly onto the Autolet Impression by twisting it on.

Autolet Impression also comes with an alternate site end cap for sampling from other parts of the body, such as the arm, which you may find more comfortable than the fingertip. Before you begin testing on an alternate site, you should read the owner's booklet that came with your blood glucose meter and talk to your healthcare professional.

These instructions are intended as a guide only. Full instructions for use are supplied with Autolet Impression and must be read in full before using the device.